

TECHNICAL DATA SHEET

GRAPHIC BLADE NO. 834



GRAPHIC BLADE NO. 834 from MARTOR is a high-quality blade made of steel with TiN-coating. It is very sharp and has one usable cutting edge. The blade is 36.5 mm long, 5.7 mm wide and 0.50 mm thick.

GRAPHIC BLADE NO. 834 is available under order number 834.65 in a safety dispenser of 100.

PRODUCT DETAILS

Order No.	NO. 834.65
Blade size (L x W)	36.5 x 5.7 mm
Material thickness	0.50 mm
Weight Blade	0.5 g
Basic material	Steel
Refinement/ Version	TiN
Ground	2-sided ground-edge
Blade facets	Double bevel edge-ground
Blade characteristics	1-cutting edge blade

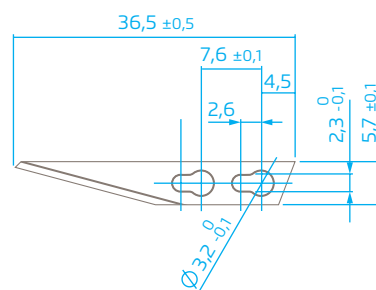

PACKAGING DETAILS

Packaging unit (PU)	100 in safety dispenser
Size PU	67 x 41 x 12 mm
Weight PU	57.0 g
EAN Code PU	4002632918759
Quantity in outer pack	10 safety-dispensers
Size outer pack	117 x 42 x 82 mm
Weight outer pack	600 g
EAN Code outer pack	4002632970078
Customs tariff number	82141000

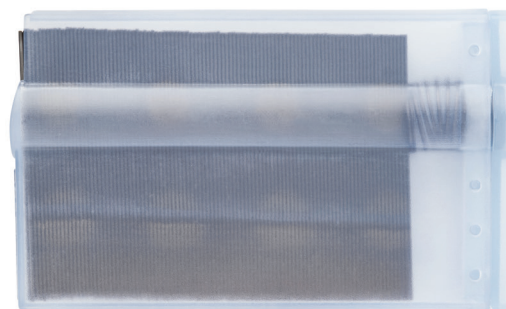

PRODUCT FEATURES

Technical features



TiN-coated



2-sided ground-edge

REMOVAL



MOUNTABLE IN

The blade can be used in the following MARTOR knives: GRAFIX 501, TRIMMEX SIMPLASTO, TRIMMEX CUTTOGRAF.

SAFETY ADVICE



CAUTION: The blade is sharp and can result in serious and deep cuts. Therefore, never reach into the blade!

Only use cutting tools that are in perfect condition with sharp, clean and undamaged MARTOR blades. Also make sure that the knife's operation is not impaired by the material to be cut or by dirt or particle deposits around the blade.

1. Replacement of spare parts: Replace any blades that become dull at the right time! Dispose of old blades in a proper fashion. They should not be placed in a waste paper bin, as this poses a considerable danger of injuries.

2. Non-use of the knife: Always secure the blade in such a way (depending on product type) that injuries due to cuts are excluded. Store the knife in a secure place.

3. Care instructions: To guarantee a long service life, always keep the knife clean and do not expose it to unnecessary soiling and humidity.

CAUTION: No liability will be assumed for consequential losses. Subject to technical changes and errors! This knife does not belong in the hands of children!

CONTACT

MARTOR KG | Lindgesfeld 28 | 42653 Solingen | Germany
T +49 212 73870-0 | info@martor.de | www.martor.com